

# PC 90

PERSIANA A BATTENTE  
CON LAMELLE FISSE O ORIENTABILI  
EFFETTO TAGLIO A 90°

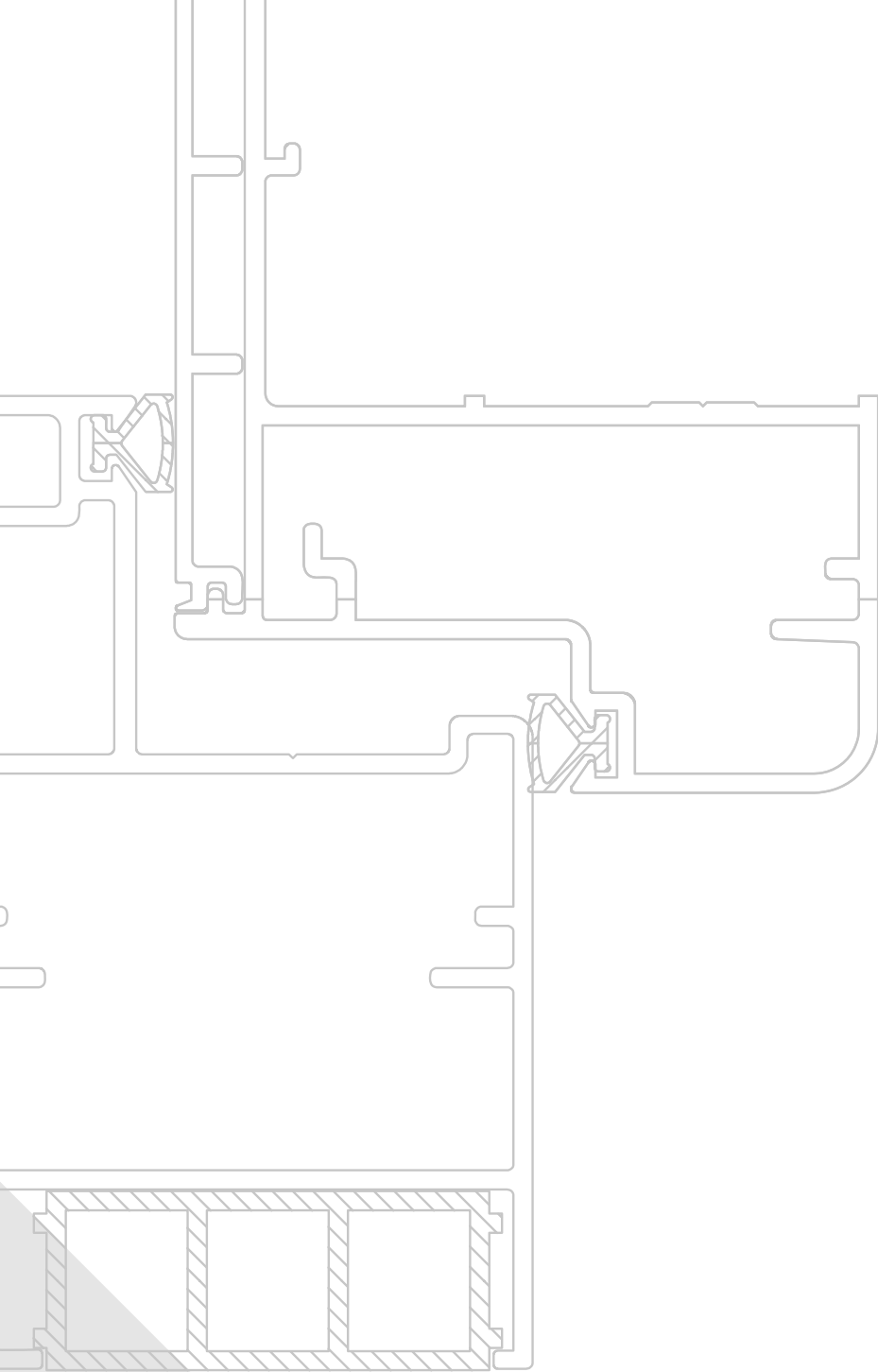





# PC 90







PERSIANA A BATTENTE  
CON LAMELLE FISSE O ORIENTABILI  
EFFETTO TAGLIO A 90°



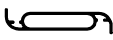

**ELENCO PROFILATI**

<b>BT 355010</b> Profilo porta-lamella Butterfly Peso kg/ml. <b>0.164</b> Perimetro mm. 105 Super. in vista m <sup>2</sup> /m. 0.070 Jx 0.00 cm <sup>4</sup> Wx 0.00 cm <sup>3</sup> Jy 00.00 cm <sup>4</sup> Wy 0.00 cm <sup>3</sup>		Tavola B 06
<b>PS45.909</b> Cartella mm.59 Peso kg/ml. <b>0.291</b> Perimetro mm. 165 Super. in vista m <sup>2</sup> /m. 0.059 Jx 0.00 cm <sup>4</sup> Wx 0.00 cm <sup>3</sup> Jy 0.00 cm <sup>4</sup> Wy 0.00 cm <sup>3</sup>		Tavola B 03
<b>CP 355010</b> Profilo compensatore Butterfly Peso kg/ml. <b>0.550</b> Perimetro mm. 272 Super. in vista m <sup>2</sup> /m. 0.089 Jx 0.00 cm <sup>4</sup> Wx 0.00 cm <sup>3</sup> Jy 00.00 cm <sup>4</sup> Wy 0.00 cm <sup>3</sup>		Tavola B 06
<b>PS45.910</b> Telaio Peso kg/ml. <b>1.090</b> Perimetro mm. 346 Super. in vista m <sup>2</sup> /m. 0.074 Jx 0.00 cm <sup>4</sup> Wx 0.00 cm <sup>3</sup> Jy 0.00 cm <sup>4</sup> Wy 0.00 cm <sup>3</sup>		Tavola B 03
<b>RX450.2981</b> Ovalina 50 x 10 Peso kg/ml. <b>0.377</b> Perimetro mm. 112 Super. in vista m <sup>2</sup> /m. 0.112 Jx 0.23 cm <sup>4</sup> Wx 0.47 cm <sup>3</sup> Jy 3.24 cm <sup>4</sup> Wy 1.62 cm <sup>3</sup>		Tavola B 04
<b>RX450.5484</b> Lamella mm.71 Peso kg/ml. <b>0.552</b> Perimetro mm. 191 Super. in vista m <sup>2</sup> /m. 0.180 Jx 0.72 cm <sup>4</sup> Wx 0.65 cm <sup>3</sup> Jy 9.56 cm <sup>4</sup> Wy 2.62 cm <sup>3</sup>		Tavola B 04
<b>RX450.13173</b> Lamella mm.71 Peso kg/ml. <b>0.570</b> Perimetro mm. 195 Super. in vista m <sup>2</sup> /m. 0.180 Jx 0.72 cm <sup>4</sup> Wx 0.65 cm <sup>3</sup> Jy 9.56 cm <sup>4</sup> Wy 2.62 cm <sup>3</sup>		Tavola B 04
<b>RX450.5485</b> Compensatore lamella 71 mm Peso kg/ml. <b>0.424</b> Perimetro mm. 212 Super. in vista m <sup>2</sup> /m. 0.105 Jx 4.40 cm <sup>4</sup> Wx 1.42 cm <sup>3</sup> Jy 0.36 cm <sup>4</sup> Wy 0.53 cm <sup>3</sup>		Tavola B 04
<b>RX450.13178</b> Adattatore per compensatore Peso kg/ml. <b>0.307</b> Perimetro mm. 165 Super. in vista m <sup>2</sup> /m. 0.023 Jx 0.22 cm <sup>4</sup> Wx 0.28 cm <sup>3</sup> Jy 1.63 cm <sup>4</sup> Wy 0.93 cm <sup>3</sup>		Tavola B 04
<b>RX450.8694</b> Zoccolo riportato Peso kg/ml. <b>0.444</b> Perimetro mm. 142 Super. in vista m <sup>2</sup> /m. 0.063 Jx 1.31 cm <sup>4</sup> Wx 1.04 cm <sup>3</sup> Jy 1.90 cm <sup>4</sup> Wy 1.17 cm <sup>3</sup>		Tavola B 03
<b>RX450.2592</b> Profilo porta-spazzolino Peso kg/ml. <b>0.238</b> Perimetro mm. 139 Super. in vista m <sup>2</sup> /m. 0.035 Jx 0.01 cm <sup>4</sup> Wx 0.03 cm <sup>3</sup> Jy 0.94 cm <sup>4</sup> Wy 0.51 cm <sup>3</sup>		Tavola B 05
<b>RX450.8698</b> Riporto centrale Peso kg/ml. <b>0.585</b> Perimetro mm. 166 Super. in vista m <sup>2</sup> /m. 0.114 Jx 2.89 cm <sup>4</sup> Wx 1.80 cm <sup>3</sup> Jy 6.90 cm <sup>4</sup> Wy 2.72 cm <sup>3</sup>		Tavola B 03
<b>PS45.908</b> Anta Peso kg/ml. <b>1.185</b> Perimetro mm. 380 Super. in vista m <sup>2</sup> /m. 0.090 Jx 0.00 cm <sup>4</sup> Wx 0.00 cm <sup>3</sup> Jy 0.00 cm <sup>4</sup> Wy 0.00 cm <sup>3</sup>		Tavola B 03
<b>RX450.70258</b> Lamella Firenze Peso kg/ml. <b>0.458</b> Perimetro mm. 157 Super. in vista m <sup>2</sup> /m. 0.156 Jx 0.00 cm <sup>4</sup> Wx 0.00 cm <sup>3</sup> Jy 00.00 cm <sup>4</sup> Wy 0.00 cm <sup>3</sup>		Tavola B 04

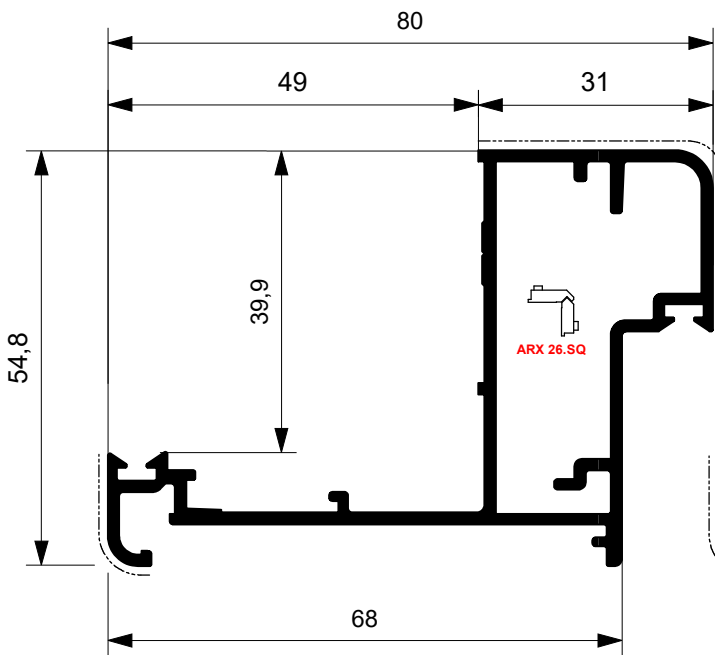

**ELENCO PROFILATI**

<b>RX450.8419</b>			Tavola B 04
Compensatore lamella 71 mm			
<b>Peso</b>	kg/ml. <b>0.447</b>		
<b>Perimetro</b>	mm. 216		
<b>Super. in vista</b>	m <sup>2</sup> /m. 0.105		
<b>Jx</b> 4.40 cm <sup>4</sup> <b>Wx</b> 1.42 cm <sup>3</sup> <b>Jy</b> 0.36 cm <sup>4</sup> <b>Wy</b> 0.53 cm <sup>3</sup>			
<b>RX450.8709</b>			Tavola B 05
Porta lamella			
<b>Peso</b>	kg/ml. <b>0.275</b>		
<b>Perimetro</b>	mm. 157		
<b>Super. in vista</b>	m <sup>2</sup> /m. 0.025		
<b>Jx</b> 0.26 cm <sup>4</sup> <b>Wx</b> 0.34 cm <sup>3</sup> <b>Jy</b> 1.29 cm <sup>4</sup> <b>Wy</b> 0.70 cm <sup>3</sup>			
<b>RX450.9392</b>			Tavola B 05
Lamella persiana			
<b>Peso</b>	kg/ml. <b>0.413</b>		
<b>Perimetro</b>	mm. 180		
<b>Super. in vista</b>	m <sup>2</sup> /m. 0.124		
<b>Jx</b> 0.22 cm <sup>4</sup> <b>Wx</b> 0.32 cm <sup>3</sup> <b>Jy</b> 5.26 cm <sup>4</sup> <b>Wy</b> 1.75 cm <sup>3</sup>			
<b>RX450.9621</b>			Tavola B 03
Fascia-zoccolo			
<b>Peso</b>	kg/ml. <b>1.234</b>		
<b>Perimetro</b>	mm. 321		
<b>Super. in vista</b>	m <sup>2</sup> /m. 0.190		
<b>Jx</b> 36.20 cm <sup>4</sup> <b>Wx</b> 7.87 cm <sup>3</sup> <b>Jy</b> 12.04 cm <sup>4</sup> <b>Wy</b> 6.02 cm <sup>3</sup>			
<b>RX450.9627</b>			Tavola B 05
Compensatore lamella			
<b>Peso</b>	kg/ml. <b>0.431</b>		
<b>Perimetro</b>	mm. 165		
<b>Super. in vista</b>	m <sup>2</sup> /m. 0.044		
<b>Jx</b> 1.97 cm <sup>4</sup> <b>Wx</b> 1.00 cm <sup>3</sup> <b>Jy</b> 1.84 cm <sup>4</sup> <b>Wy</b> 0.76 cm <sup>3</sup>			
<b>SA 25987</b>		 <small>RX450.70258                      Agni 0-028                      --- mm. 156</small>	Tavola B 08
Doga 110 x 23.5			
<b>Peso</b>	kg/ml. <b>0.662</b>		
<b>Perimetro</b>	mm. 326		
<b>Super. in vista</b>	m <sup>2</sup> /m. 0.220		
<b>Jx</b> 0.00 cm <sup>4</sup> <b>Wx</b> 0.00 cm <sup>3</sup> <b>Jy</b> 00.00 cm <sup>4</sup> <b>Wy</b> 0.00 cm <sup>3</sup>			

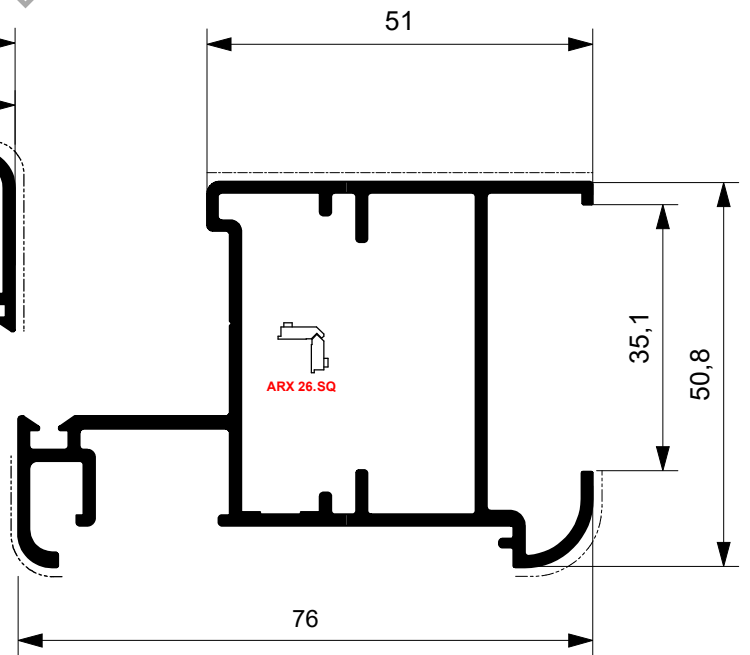

**PS45.910**

Kg/ml 1.090  
--- mm. 74



**PS45.908**

Kg/ml 1.185  
--- mm. 90

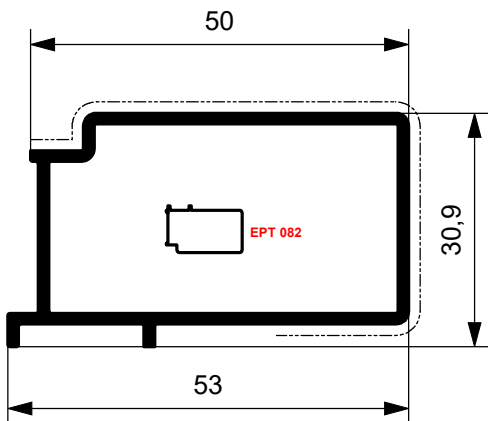

**RX450.5671**

Kg/ml 0,596

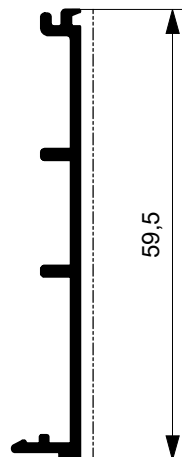

**PS45.909**

Kg/ml 0.291  
--- mm. 59

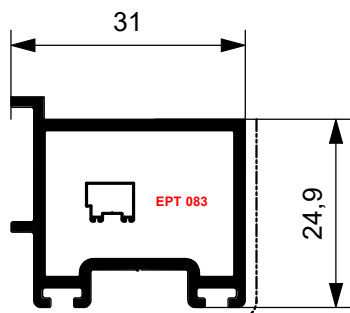

**RX450.5796**

Kg/ml 0,454

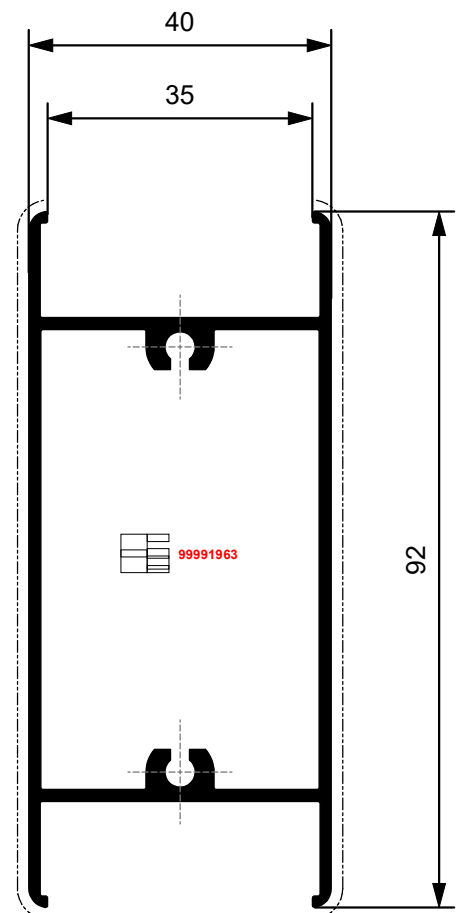

**RX450.9621**

Kg/ml 1,234  
--- mm. 190

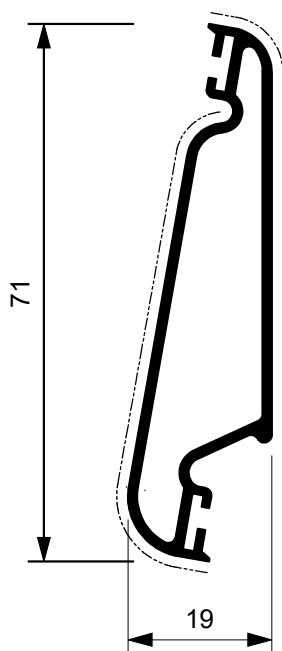

**RX450.13173**

Kg/ml 0,570  
--- mm. 180

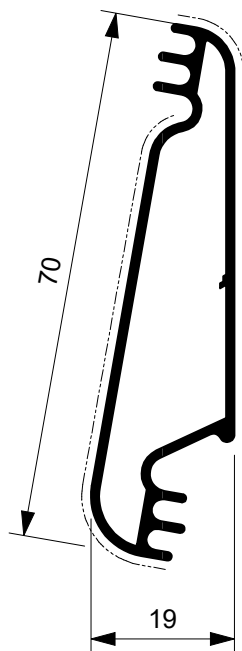

**RX450.5484**

Kg/ml 0,552  
--- mm. 180

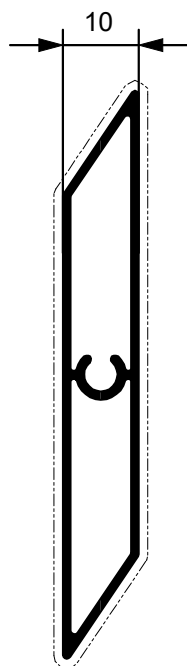

**RX450.70258**

Kg/ml 0,458  
--- mm. 156

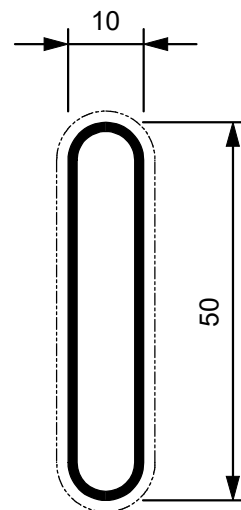

**RX450.2981**

Kg/ml 0,377  
--- mm. 112

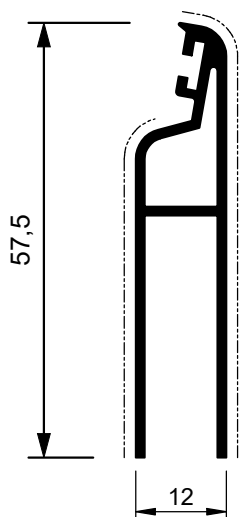

**RX450.8419**

Kg/ml 0,447  
--- mm. 105

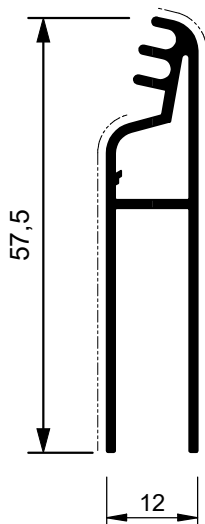

**RX450.5485**

Kg/ml 0,424  
--- mm. 105

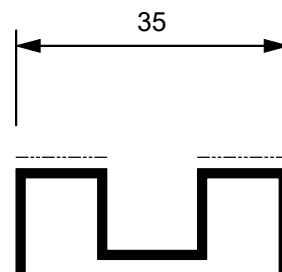

**RX450.13178**

Kg/ml 0,447  
--- mm. 23

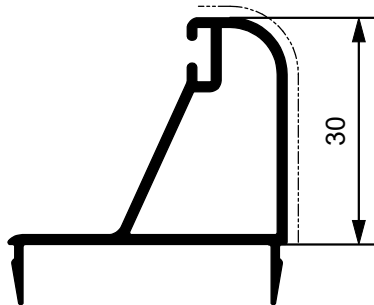

**RX450.9627**

Kg/ml 0,431

--- mm. 44

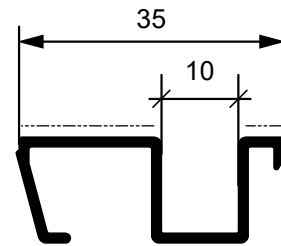

**RX450.8709**

Kg/ml 0,275

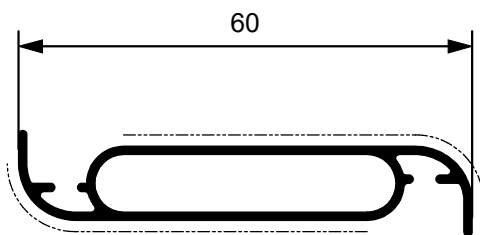

**RX450.9392**

Kg/ml 0,413

--- mm. 124

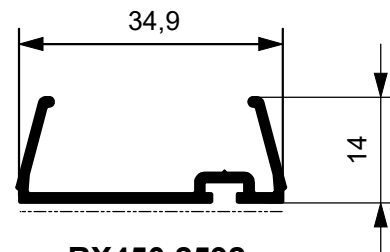

**RX450.2592**

Kg/ml 0,238

--- mm. 35





**Profili Butterfly**  
per lamella ovale 50 x 10

Asole ovali 50 x 10

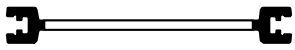

Asole ovali 50 x 10

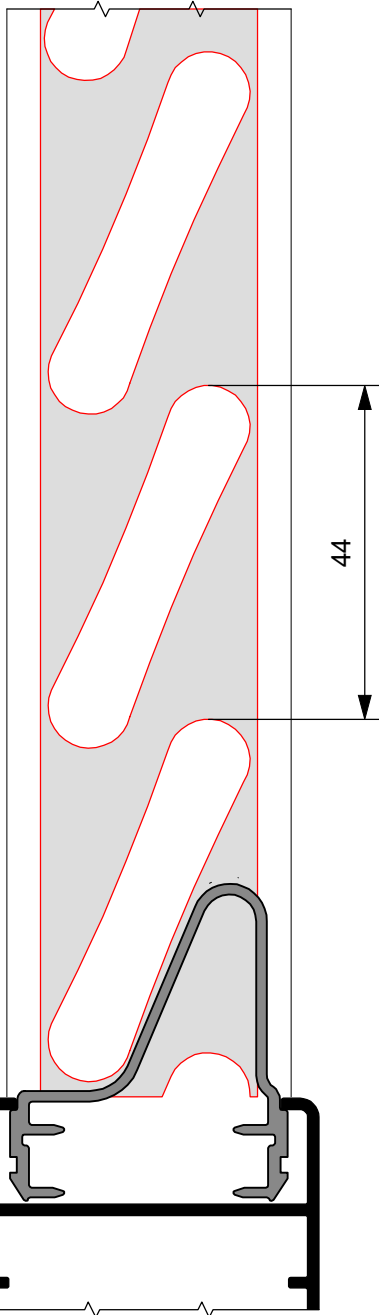

**Compensazione minima**

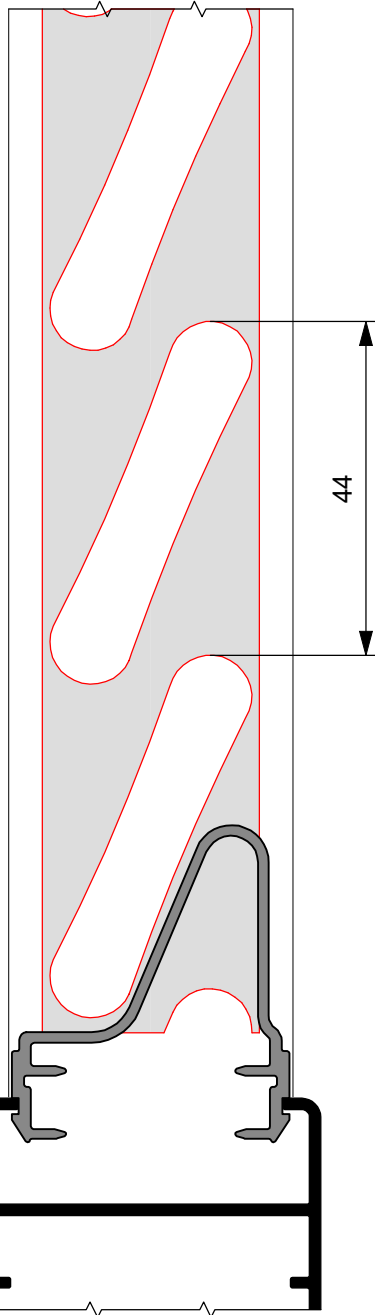

**Compensazione massima**

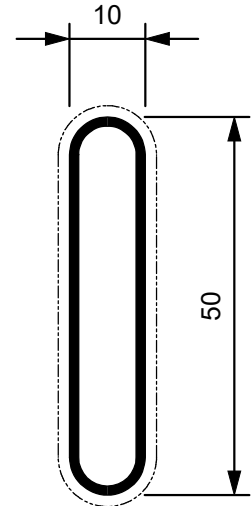

**RX450.2981**

Kg/ml 0,377

--- mm. 112

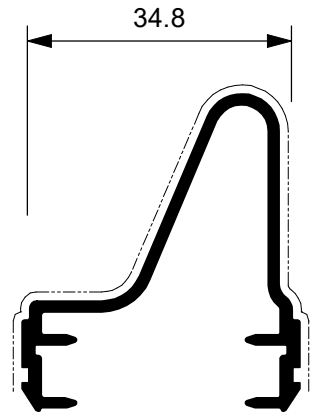

**CP 355010**

Kg/ml 0,550

--- mm. 89

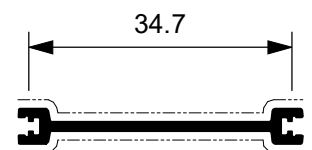

**BT 355010**

Kg/ml 0,164

--- mm. 70

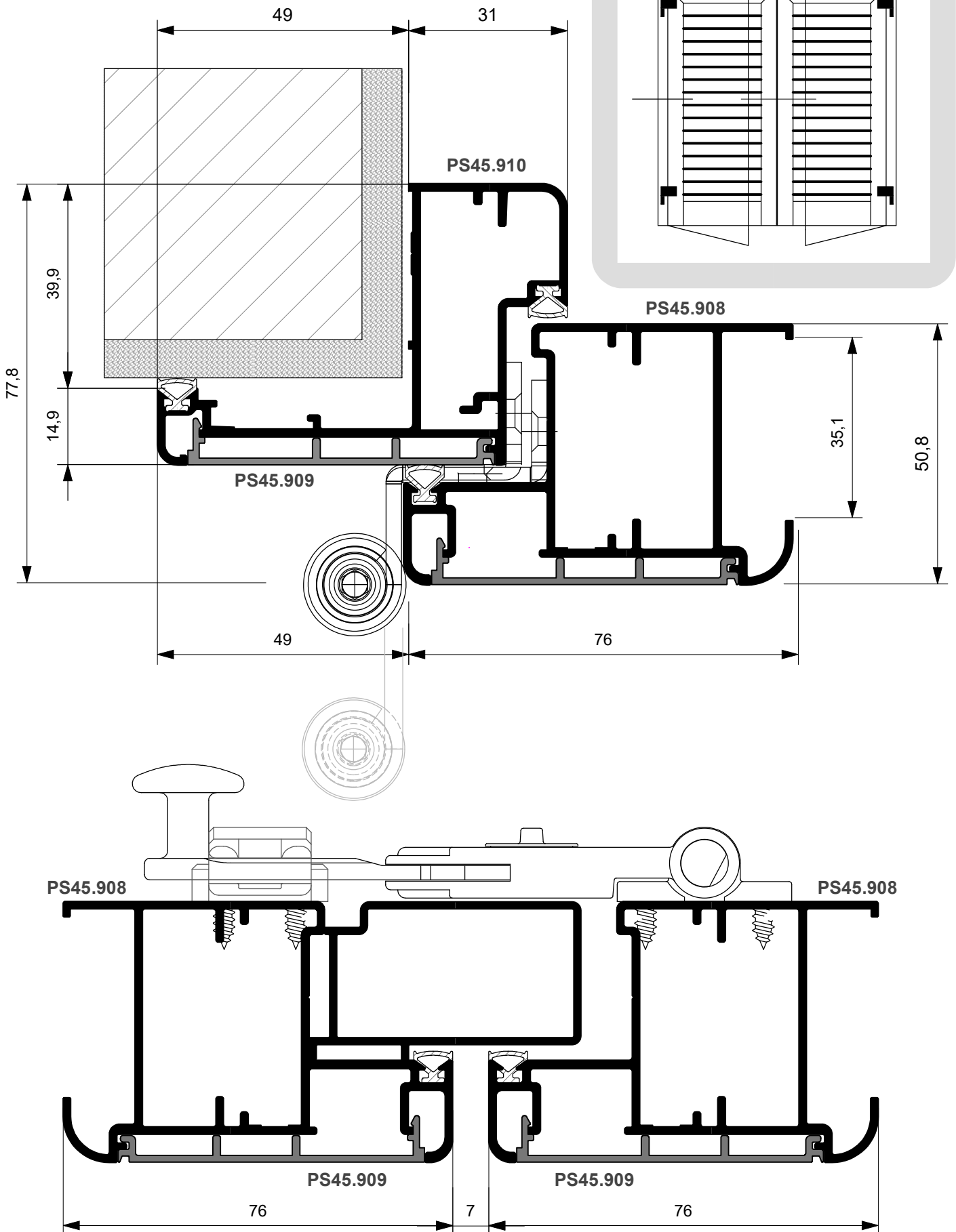

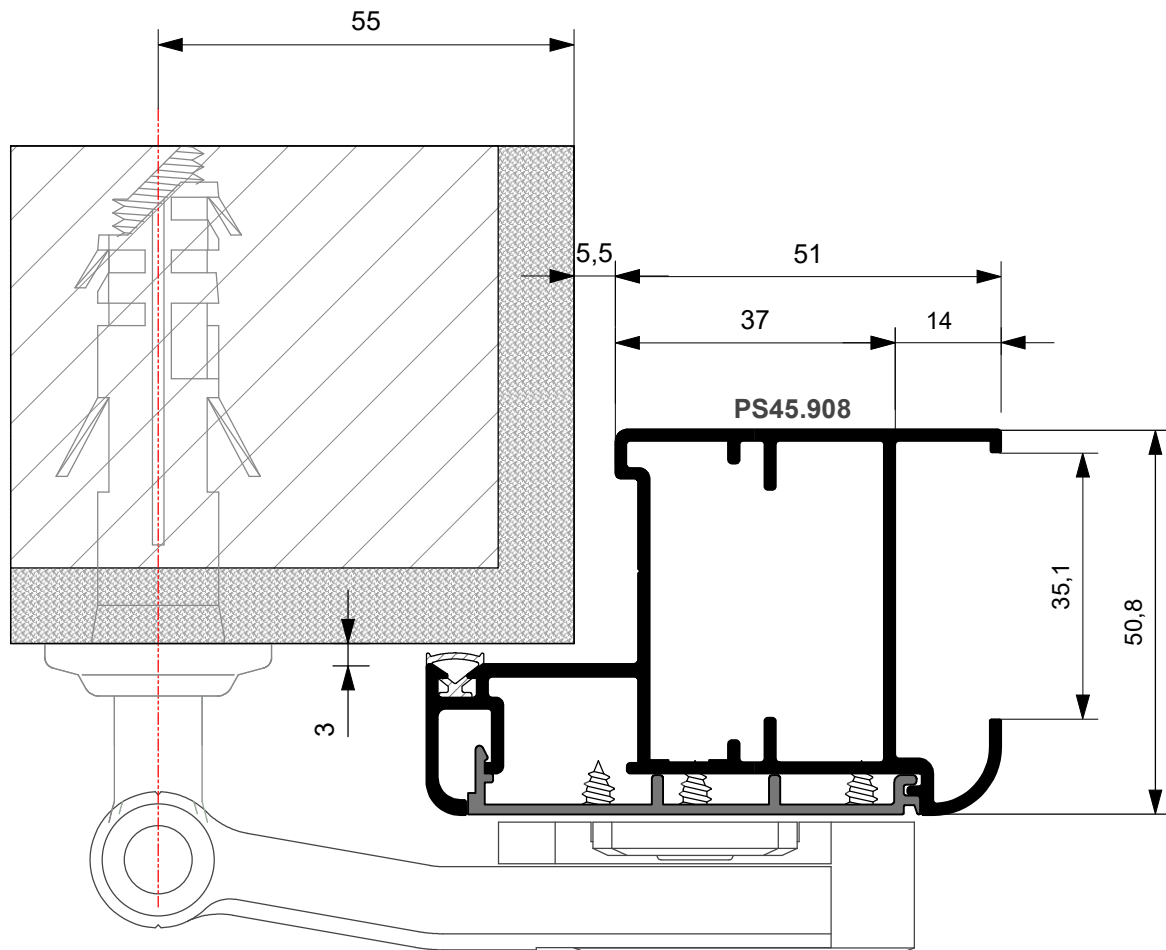
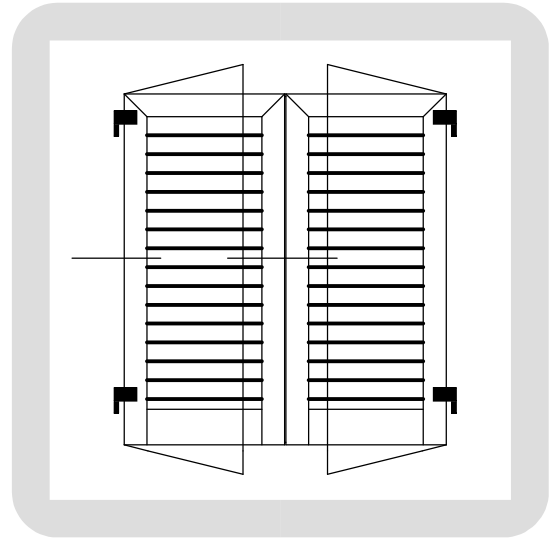

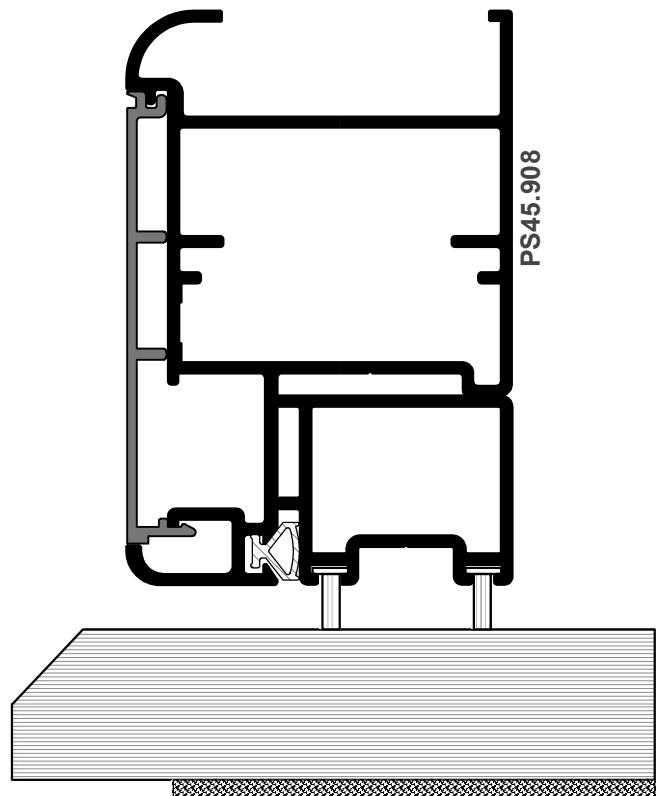
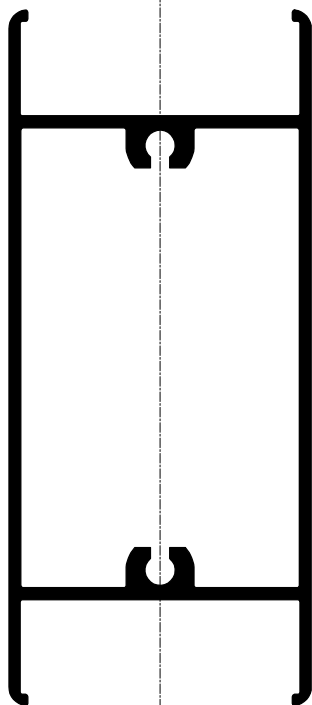
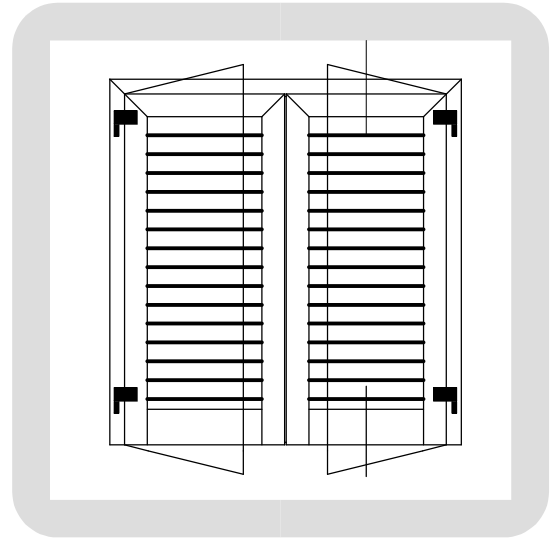
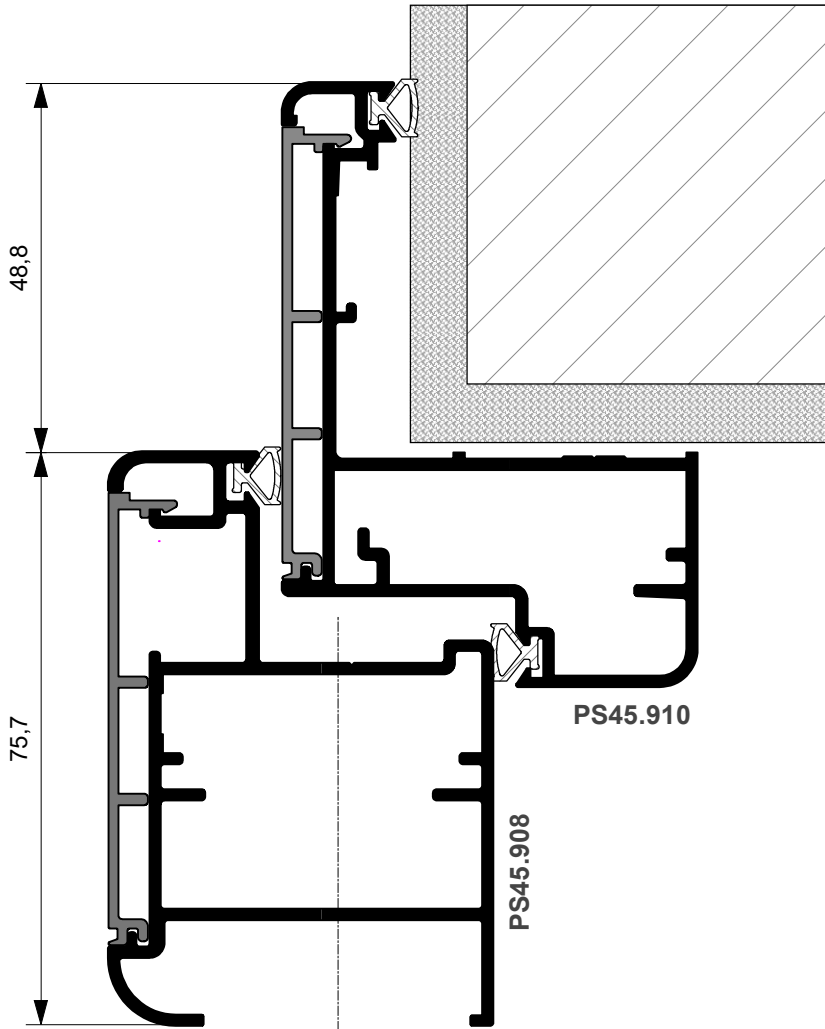

**PAM SYSTEM S.r.l.**  
13030 Formigliana (VC)  
S.S. 230 - Fornace Crocicchio  
Tel. 0161 858811 - Fax 0161 858800  
www.pamsystemsrl.com - info@pamsystemsrl.com

**S.A.F. S.r.l.**  
Via Bonati, 21 - 29017 Fiorenzuola D'Arda (PC)  
Tel. 0523 943228 - Fax 0523 941127  
info@saf-srl.com

**PAESANI S.r.l.**  
Via Emilia, 41 - 47921 Rimini  
Tel. 0541 748511 - Fax 0541 741208  
www.paesani.com - info@paesani.com

**ALUK GROUP CENTRO DI FIRENZE**  
Piani della Rugginosa, 203/206  
Tel. 055 8662351/352 - Fax 055 8662065  
55066 Reggello (FI)

**DI.VA S.r.l.**  
Via Po, 25 - Z. I. Sambuceto  
66020 San Giovanni Teatino (CH)  
Tel. 085 4405210 - Fax 085 4405207  
www.camel-diva.com - info@camel-diva.com

**EUROALL S.r.l.**  
Str. Comunale della Mola Saracena, 23  
00065 Fiano Romano (RM)  
Tel. 0765 455228/61 - Fax 0765 455317  
info@euroallslrl.it

06083 Bastia Umbra (PG)  
Tel. 075 8012385-075 8010328 - Fax 075 8012386  
profilatumbria@virgilio.it

**TSL ALLUMINIO S.r.l.**  
Via di Torre Spaccata, 172 - 00169 Roma  
Tel. 06 2251591 (Ric. Aut.) - Fax 06 2280693  
info@tslaluminio.it

**ALLCAR SERVICE S.r.l.**  
Via Acuto, 120 - 00131 Roma  
Tel. 06 4130626 (Ric. Aut.) - Fax 06 4130367  
allcarservice@mclink.it

**CARUSO S.r.l.**  
Z.I. Contrada Le Macere  
86019 Vinchiatturo (CB)  
Tel. 0874 340024 - Fax 0874 340025  
carusosrl1@libero.it

**ALLUCOM S.r.l.**  
Via Vecchia Barletta 237  
Z. Ind. - 76123 Andria (BT)  
Tel. 0883 592213 - Fax 0883 552386  
www.allucom.com - info@allucom.com



**SALENTO METALLI S.r.l.**  
Via Federico II, 13 - Zona PIP  
73020 Cavallino (LE)  
Tel. 0832 614576 - Fax 0832 614635  
www.salentometalli.it - info@salentometalli.it

**MIDA ALLUMINIO S.r.l.**  
Via Piano del Principe, 36  
80047 San Giuseppe Vesuviano (NA)  
Tel. 081 5297373 - Fax 081 8284449  
www.midaalluminiogroup.it - info@gruppomida.it

**MIDA ALLUMINIO S.r.l.**  
Loc. Terzerie - Z. Ind.  
80061 Ogliastro Cilento (SA)  
Tel. 0974 833233 - Fax 0974 844724  
www.midaalluminiogroup.it - info@midaalluminiogroup.it

**COMAS S.r.l.**  
Via Porta Palermo, 84 - 91011 Alcamo (TP)  
Tel. 0924 507050 - Fax 0924 507051  
www.comasgroup.it - info@comasgroup.it

**ITALBACOLOR S.r.l.**  
C.da Valle S. Maria - 87020 Fuscaldo (CS)  
Tel. 0982 618025 - Fax 0982 720235  
www.italbacolor.it - info@italbacolor.it



**Consorzio TWIN SYSTEMS**  
Via di Torre Spaccata, 172  
00169 ROMA  
Tel./Fax 06 23260298



info@twinsystems.it  
www.twinsystems.it